



TECHNICAL
INSTALLATION
MERU EMERGENCY

APPROVAL

	NAME	SIGNATURE	POSITION	DATE
PREPARED BY:				
REVIEWERD BY:				
APPROVED BY:				

1.1. TECHNICAL INFORMATION

1.1.1. Power data

RATED POWER	24- 48W
INPUT VOLTAGE RANGE	190 – 277 VAC 50/60Hz
INPUT TYPE (AC/DC)	AC – Alternating current
CONNECTED POWER	25 – 50W
POWER FACTOR	>0.9

1.1.2. LED data

LED BARND	Seoul semiconductor®
CCT	3000 – 5000 Kelvin
CRI	≥80
LED RATED LIFE TIME	80 000 hours

1.1.3. Luminaire data

IP RATING	IP65
BEAM ANGLES	120°, 30°, 60°, 155°x80°
DIMMABILITY	None
MOUNTING POSITION	Universal

1.1.4. Luminaire physical characteristics

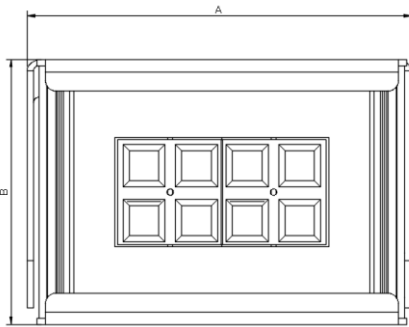
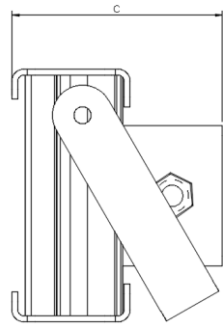
Product description Wattage and sizes				
	24W	48W		
A (mm)	175	175		
B (mm)	120	170		
C (mm)	100	100		
Weight (kg)	1.6	2		

1.1.5. Emergency control gear physical characteristics

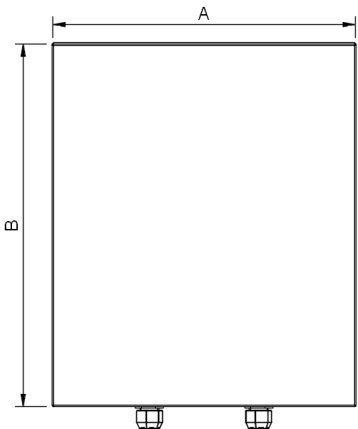
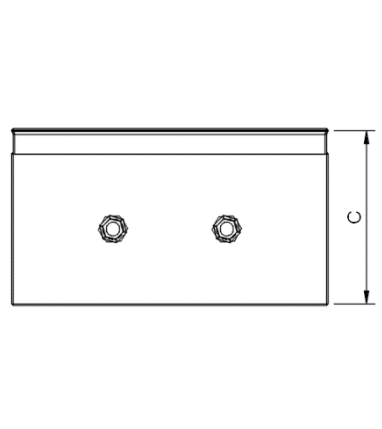
Product description				
	1 Hour	4 Hour		
A (mm)	200	200		
B (mm)	250	250		
C (mm)	150	150		
Weight (kg)	2.5	3.2		

1.2. INSTALLATION INSTRUCTION

1.2.1. Part number break down.

Part no. example. FL - 24 - S6 - C - S - 12V - EME -1

LUMINAIRE DESCRIPTION	WATTAGE	Series	CCT-COLOUR TEMPERATURE	Lens	Voltage	HOURS
FL- Floodlight	24W 48W	Series 6	W - 3000K - warm white N - 4000K - Neutral white C - 5000K - Cool white	S - Strada M - 30° W - 60° D - 120°	12v	1- 1hour 4- 4hour

1.2.2. Diagrams/drawings

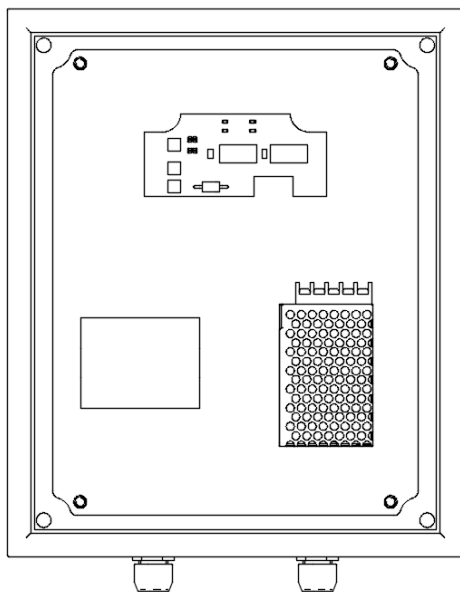

Figure 1 Emergency control gear

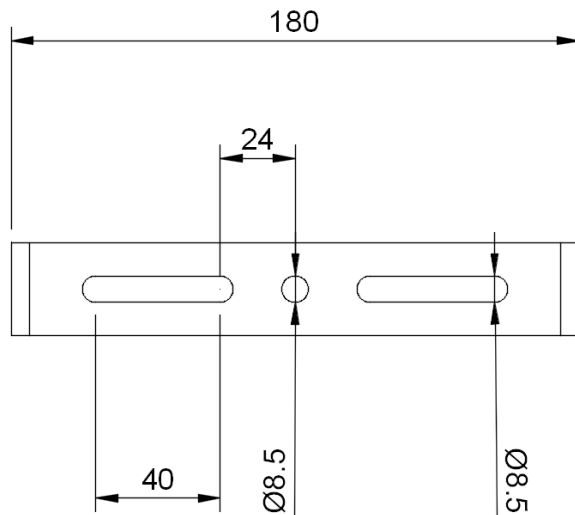

Figure 2 Floodlight U-bracket

1.2.3. Installation instructions

The Installation must be carried out by a Qualified Electrician in compliance with the local code of practice.

Tools required:

Dependent on fasteners that will be used the tools may vary.

- Step 1. To install Meru floodlight special attention needs to be given to the mounting holes on the luminaire mounting bracket. The length and width of the luminaire also plays a role as where to fit the luminaire.
- Step 2. To connect to the mains 220VAC confirm main power is switched off.
- Step 3. Low Profile Lights require mains Voltage of between 190 to 277VAC 50 Hz. Powering these lights by connecting the mains cable can be to put on a 3-pin plug, or with a connector block (Chock Block), or quick connector. Connect the corresponding wires, Brown (L), Blue (N), and Yellow/Green (E). Always read the Label on the luminaire body to make sure the voltage is correct. When powering the light, the light should come on immediately, with no strike delay.